

AKASO

EK7000

ACTION CAMERA



USER MANUAL

V35AS

Contents

What's in the Box -----	02	>>
Your EK7000 -----	04	>>
Getting Started-----	07	>>
Overview of Modes-----	09	>>
Customizing Your EK7000 -----	11	>>
Connecting to the AKASO GO App -----	15	>>
Playing Back Your Content -----	17	>>
Transferring Your Content-----	18	>>
Reformatting Your Memory Card -----	19	>>
Maintaining Your Camera-----	19	>>
Maximizing Battery Life-----	20	>>
Battery Storage and Operation -----	20	>>
Remote -----	21	>>
Mounting Your Camera-----	24	>>
Contact Us-----	25	>>



What's in the Box



AKASO EK7000
x 1



Waterproof
Housing x 1



Battery Charger
x 1



Battery
x 2



USB Cable
x 1



Remote Control
x 1



Remote Control
Strap x 1



Protective
Backdoor x 1



Clip
x 1



Clip 2
x 1



Buckle Mount
x 1



J-Hook Mount
x 1



A Mount
x 1



C Mount
x 1



D Mount
x 1



F Mount
x 1



E Mount
x 1



H Mount
x 1



Helmet Mounts
x 2



Spanner
x 1



Bandage
x 4



Tether
x 5



Lens Cloth
x 1



Double Sided
Adhesive Tape x 2



Quick Start
Guide x 1



How to use all sorts of accessories of the action camera?

For more details about using the included accessories in different scenarios, scan the provided QR code or enter the attached website to get an instruction video.



<https://youtu.be/OPGMboYrLb0>

Unboxing **0:00-0:15**

How to remove the camera from the packing box? **0:16-0:22**

How to remove the camera from the waterproof housing? **0:23-0:27**

How to detach the waterproof case from the mount buckle? **0:30-0:41**

(Rotate the buckle mount counterclockwise with the spanner.) **0:32-0:41**

How to mount the camera to a self stick? 0:42-0:56

(Install the camera onto the clip before mounting.) **0:42-0:48**

How to mount the camera onto a tripod? **0:59-1:17**

How to mount the camera onto your body? **1:18-1:35**

(Clamp the Clip 2 to the camera). **1:24-1:28**

(Clamp the camera to your bag or your clothes). **1:29-1:35**

How to install the camera to the waterproof housing? **1:36-1:50**

(Open the buckle of the housing and detach the protective backdoor.)

1:38-1:43

(Put the camera in the waterproof case, reinstall the backdoor, and fasten the buckle.) **1:45-1:50**

How to replace the protective backdoor? **1:51-2:06**

(Open the buckle, take the camera out of the waterproof case.) **1:52-1:55**

(Detach the back door and install a new back door onto the case.) **1:56-2:00**

How to mount the camera onto a bike? **2:01-2:58**

(Bind the camera with a tether to in case it falls from the bike during your ride.) **2:50-2:58**

How to mount the camera onto different helmets? **2:59-5:38**

Your EK7000

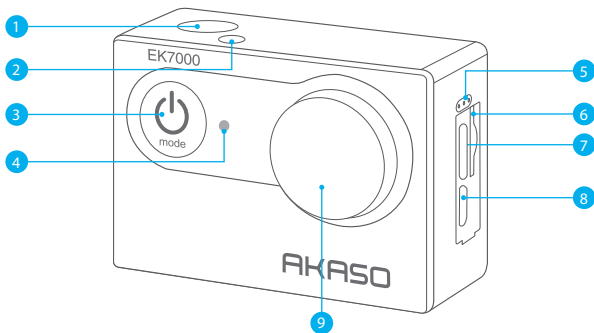

- ① Shutter/Select/OK Button
- ② Working /Wifi Indicator
- ③ Power / Mode/Exit Button
- ④ Charging Indicator
- ⑤ Microphone
- ⑥ Memory Card Slot
- ⑦ USB/External Mic Port
- ⑧ Micro HDMI Port
- ⑨ Lens



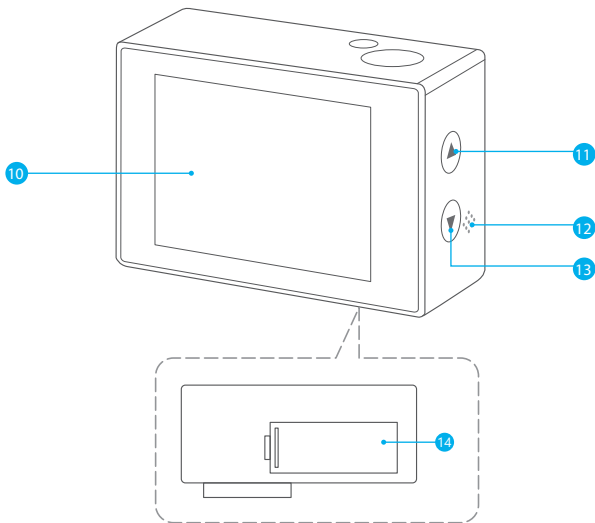

- 10 Display Screen
- 11 Up/Playback Button
- 12 Speaker
- 13 Down/Wifi Button
- 14 Battery Cover



- ① Shutter / Select Button
- ② Up / Playback Button
- ③ Down / Wifi Button
- ④ Bolt
- ⑤ Power / Mode / Exit Button

Note: The camera does not record sound when it is in the waterproof case.

Getting Started

Welcome to your new EK7000. To capture video and photos, you will need a memory card (sold separately).

Using Memory Cards

Use brand name memory cards that meet these requirements:

- Class 10 or UHS-I rating
- Capacity up to 256GB (FAT32)

Note:

1. When the camera is turned on for the first time or reset, the quick setup page will pop up. Please set the language and date & time before using the camera.
2. Please format the memory card first in this camera before using. To keep your memory card in good condition, reformat it on a regular basis. Reformatting erases all of your content, so be sure to offload your photos and videos first.
3. Memory cards larger than the specified maximum capacity can cause issues like non-recognition or even camera malfunctions like unresponsiveness or firmware failure.

Installing the Memory Card

First locate the memory card slot, then insert the memory card with the label facing the display screen. To remove the card, simply press it into the slot with your fingernail, and it will then pop out.

Note: Be sure to turn off the camera before installation.

Installing the Battery

Press the buckle of the battery cover to open it, then place the battery into its slot and close the battery cover. To remove the battery, pull the battery strip.



Charging the Camera

Locate the USB power port, and connect the camera to a USB adapter or computer using the USB cable. The charging indicator will be flashing red while charging, and black out when fully charged. Once fully charged, disconnect the cable.

Tip: You can also charge the battery separately using the included battery charger; the camera can be fully charged in 1 hour and last around 90 minutes of runtime in 1080P video recording; the actual battery life may vary based on the environment and usage.

Powering on or off

To Power on:

While the camera is off, press and hold the Power button for 3 seconds to turn it on. Once the display screen shows camera information and the working indicator turns on, you'll know that your camera is powered on.

To Power off:

While the camera is on, press and hold the Power button for 3 seconds to turn it off. The working indicator will also turn off.

Turning Wifi on or off

To turn on:

On the preview screen, press the Down / Wifi button to turn on Wifi. The Wifi indicator will be flashing slowly. Note: If the camera's Wifi is activated but not linked to the app within 3 minutes, it will auto-disable. Re-activate the camera's Wifi to reconnect to the app.

To turn off:

On the Wifi screen, press the Down / Wifi button to turn off Wifi.

Switching Modes

To switch mode:

On the preview screen, press the Mode button to switch modes among Video, Photo, Burst Photo, Time Lapse, and Settings.

To exit mode:

Press the Mode button to exit the current mode. To exit the Settings mode, simply press the Shutter button.

Zooming in or out

On the preview screen, press and hold the Up or Down button to zoom in or out. Each press will incrementally zoom in or out by 0.5x. The EK7000 action camera supports up to 4x zoom.

Note: The zoom feature is only available in Photo Mode, and you can only zoom in or out when taking photos at photo resolutions lower than 12MP.

Using the Shutter Button

In Photo or Video mode, press the Shutter button to capture photos or start video recording. To stop recording in Video mode, press the Shutter button again.

Tip: The working indicator flashes slowly during video recording and once during photo shooting.

Entering the Settings Screen

On the preview screen, press the Mode button several times to enter the camera's settings screen. From there, you can configure the video, photo, and system settings.

Entering the Playback Screen

On the preview screen, press the Up button to enter the playback screen. From there, you can choose either video or photo files for playback.

Overview of Modes

The camera boasts 5 modes: Video, Photo, Burst Photo, Time Lapse, and Settings. On the preview screen, press the Mode button to switch modes.



Video Mode

The camera is in Video mode by default when turned on.

In this mode, press the Shutter button to record normal video at the preset resolution and frame rate. Press the Shutter button again to stop recording.



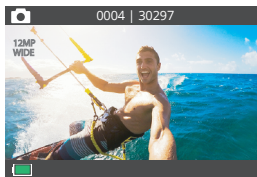
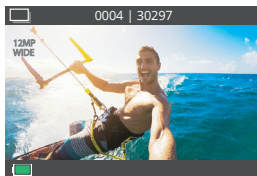

Photo Mode

On the preview screen, press the Mode button once to switch to Photo Mode.

In this mode, press the Shutter button to take a photo at the preset photo resolution.



Burst Photo Mode

On the preview screen, press the Mode button twice to switch to Burst Photo Mode.

In this mode, press the Shutter button to take 3 photos per second.

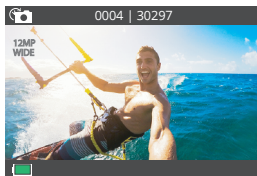

Time Lapse Photo Mode

On the preview screen, enter the camera's settings screen to enable Time Lapse Photo, then press the Shutter button followed by the Mode button to return to the preview screen, and the camera will enter Time Lapse Photo.

In this mode, press the Shutter button, and the camera captures a series of photos at the set self-timer interval, and then combines them into a video.



Time Lapse Video Mode

On the preview screen, enter the camera's settings screen to enable Time Lapse Video, then press the Shutter button followed by the Mode button to return to the preview screen, and the camera will enter Time Lapse Video mode.

In this mode, press the Shutter button to create video clips by capturing frames at the set interval.

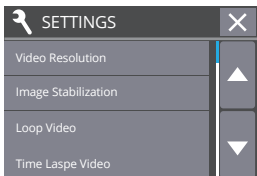

Settings Mode

On the preview screen, press the Mode button several times till you see the settings icon, and press the Shutter button to enter Settings mode.

In this mode, press the Up or Down button to browse through options, and press the Shutter button to confirm your selected option.

Customizing Your EK7000

Video & Photo Settings

1. Video Resolution

4K30fps / 2.7K30fps / 1080P60fps / 1080P30fps / 720P120fps / 720P60fps
(Default setting is 4K30fps)

Configure the resolution settings before recording videos. The camera records up to 4K 30fps videos.

Note: Capturing high-resolution or high-fps videos in warm environments can cause the camera to heat up and consume more power; 4K and 2.7K video resolutions are not available when Loop Recording or Time Lapse Video is enabled.



2. Image Stabilization

Off / On (Default setting: Off)

Image Stabilization can efficiently smooth out the lens shakes, resulting in smooth and pristine videos. This feature is ideal for capturing scenes involving activities like riding, skating, and handheld use.

3. Loop Recording

Off / On (Default setting: Off)

With Loop Recording enabled, the camera records and saves a 10-minute video. When the memory is full, new video files will overwrite the old ones to ensure continuous recording.

Note: When Loop Recording is enabled, the camera does not record 4K and 2.7K videos.

4. Time Lapse Video

Off / 1s / 3s / 5s / 10s / 20s / 30s / 60s (Default setting: Off)

Time Lapse Video creates video from frames captured at specific intervals. This option enables you to set how often your camera captures a frame of video.

Note: Time Lapse Video is captured without audio; 4K and 2.7K resolutions are not available for Time Lapse Video mode.

5. Photo Resolution

20MP / 16MP / 14MP / 12MP / 8MP / 5MP / 4MP (Default setting: 20MP)

Set the photo resolution before capturing photos. This camera is capable of capturing up to 20MP photos.

6. Self-timer

2s / 3s / 5s / 10s / 20s / 30s / 60s (Default setting: 5s)

Set the interval at which the camera captures photos in Time Lapse Photo mode.

7. Time Lapse Photo

Off / On (Default setting: Off)

With Time Lapse Photo enabled, this camera captures a series of time lapse photos at the set Self-timer interval, and then compiles them into a video. When disabled, the camera will capture a single photo instead.

8. Burst Photo

3 Photos

In Burst Photo mode, the camera captures 3 photos in 1 second, so it is perfect for capturing fast-moving activities.

System Settings

1. Microphone

Built-in / External (Default setting: Built-in)

You have the option to select either a built-in microphone or an external one. To use an external microphone (sold separately) for better sound quality, select the "External" option first. Then, connect a compatible external microphone to the camera's USB port.

Tip: If you do not wish to use an external microphone, be sure to select the "Built-in" in case the camera does not properly record sound during video recording.

2. Special Effect

Normal / Black & White / Retro / Negative / Warm / Cool / Red / Green / Blue
(Default setting: Normal)

Choose an ideal special effect for your photos or videos to enhance their appeal.

3. Exposure

-2.0 / -1.7 / -1.3 / -1.0 / -0.7 / -0.3 / 0.0 / +0.3 / +0.7 / +1.0 / +1.3 / +1.7 / +2.0
(Default setting: 0.0)

By default, your camera utilizes intelligent analysis of the entire image to determine the optimal exposure level. However, with the remarkable Exposure feature, you now have the ability to designate a specific area that takes priority in determining the ideal exposure. This invaluable setting proves particularly useful when capturing shots where critical regions may otherwise suffer from over or underexposure. As you make adjustments, the display promptly showcases the immediate impact on your image, guaranteeing that you never miss a moment. When you switch modes, the camera seamlessly reverts back to utilizing the complete scene for precise exposure calculation.

4. Date Stamp

Off/On (Default setting: On)

With Date Stamp enabled, the camera will add a watermark to your videos or photos.

5. Language

English / 简体中文 / 繁體中文 / Italiano / Español / Português / Deutsch / Dutch / Français / Čestina / Polski / Türk / Русский / Română / 日本語 / 한국어 / Thai
(Default setting is English)

Set the system language that appears on the camera.

6. Date & Time

Manually set the camera's date and time according to your local time. The date and time will also be automatically updated when you connect your camera to the AKASO GO app.

Note: If you replace the battery, the date and time will reset to the default values.

7. Sound Indicator

Shutter: On / Off (Default setting: On)

Start-up: On / Off (Default setting: On)

Beep: On / Off (Default setting: On)

Volume: 0 / 1 / 2 / 3 (Default setting: 3)

You can turn Shutter, Start-up and Beep sound on or off or adjust the camera's volume.

8. Upside Down

Yes / No (Default setting is No)

This setting determines the orientation of your videos or photos to prevent upside down footage.

Note: The user interface will be upside-down when Upside Down is enabled.

9. Power Frequency

50Hz / 60Hz / Auto (Default setting: 60Hz)

Choose the line frequency at which the video is recorded.

10. Screen Saver

Off / 1 min / 3 min / 5 min (Default setting: 1min)

Turns off the LCD display after a period of inactivity to save battery life. To turn on the LCD display again, press any buttons on the camera.

11. Auto Power off

Off / 1 min / 3 min / 5 min (Default setting: 3 min)

Powers off your EK7000 after a period of inactivity to save battery life.

12. Format

No / Yes (Default setting: No)

To keep your memory card in good condition, reformat it on a regular basis. Reformatting erases all of your content, so be sure to offload your photos and videos first.

13. Reset

No / Yes (Default setting: No)

This option resets all settings to their default values.

14. Version

You can check the model and the updated time of your EK7000.

Connecting to the AKASO GO App

To connect your camera to the AKASO GO app, please download this app from the App Store or Google Play to your smartphone first. When your camera is connected to the AKASO GO app, you can control it to capture, or change its settings using your phone. You can also live preview, playback, download, edit, and share videos via this app. Follow the instructions below to connect your camera to the AKASO GO app.

1. Turn on the camera, press the Down /Wifi button to turn on the Wifi. The camera will enter Wifi mode and display the Wifi information in 3 seconds.

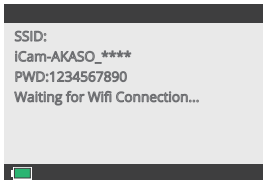

2. Enter your phone's Wifi settings page, find the Wifi named "EK7000" in the list and tap on it, then enter the password 1234567890 for connection.

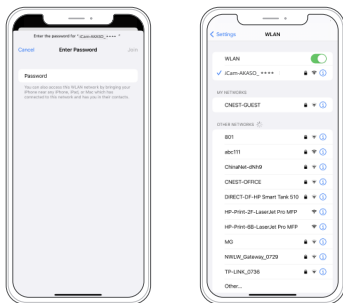

3. Open the AKASO GO app on your smartphone, then tap "Device" → "Add Device" to choose EK7000 from the options for connection.

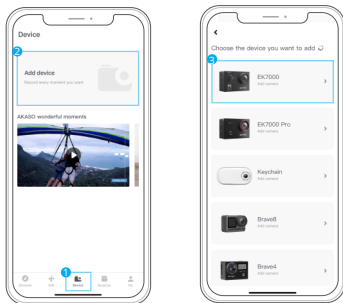

4. Tick "The above operation has been confirmed", and tap "Live Preview". Your camera will be connected to the AKASO GO app in seconds.

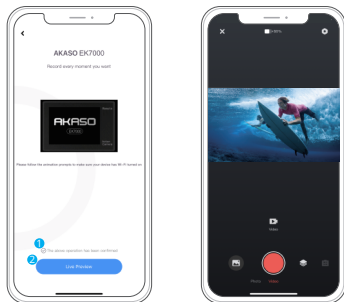

Playing Back Your Content

You can play back your content on the camera, your computer, TV, smartphone or tablet. You can also play back content by inserting the memory card directly into a device, such as a computer or a compatible TV. With this method, playback resolution depends on the resolution of the device and its ability to play back that resolution.

Viewing Your Videos or Photos on the EK7000

1. On the preview screen, press the Up button to enter the playback screen.
Note: If your memory card contains a lot of content, it might take a minute for it to load.
2. Enter the Video or Photo set, press the Up or Down button to scroll through the video or photo files, and locate the file you want to view.



3. Press the Shutter button to open the video or photo file in full-screen view. And it will play.
4. To return to the thumbnails screen, press the Mode button.
5. To exit the album, press the Mode button.

Deleting Videos or Photos on Your EK7000

1. On the preview screen, press the Up button to enter the playback screen.
Note: If your memory card contains a lot of content, it might take a minute for it to load.
2. Enter the Video or Photo set, press the Up / Down button to scroll through the video or photo files.
3. Press the Up or Down button to locate the file you want to delete.
4. Press and hold the Shutter button for 3 seconds, the screen shows "Delete this file? No/Yes".
5. Press the Up button followed by the Shutter button, and the selected file will be deleted.

Transferring Your Content

Transferring Your Content to a Computer

You can transfer your content to a computer via a USB cable or a card reader (sold separately). To transfer files to your computer via a USB cable, connect your camera to the computer's USB port using the USB cable. When prompted, select "USB Storage" as your connection preference. To transfer files to the computer using a card reader, insert a memory card into the card reader, then connect the reader to your computer's USB port. After successful transmission, you can transfer the files to your computer or delete selected files using File Explorer.

Downloading Your Content to a Smartphone

1. Open the AKASO GO app, then connect it to the camera.



2. Tap the Album icon in the bottom left corner to view all the photos and videos captured by the camera.
3. Tap the Select icon in the upper right corner to select the video or photo you want to download, then tap the Download icon in the bottom right corner. Patiently wait for the download process to complete. The file will be successfully saved to your phone's photo album.

Note:

1. Please do not alter Wifi settings or disconnect from the app during the download progress.
2. If you cannot download videos or photos to your iPhone via the app, please enter your phone's Settings page → Privacy → Photos, find "AKASO GO", and select "All photos".
3. iPhone does not allow you to download 4K or 2.7K videos via the app. Please transfer these videos to your computer.

Reformatting Your Memory Card

To keep your memory card in good condition, reformat it on a regular basis. Reformatting erases all of your content, so be sure to offload your photos and videos first.

1. Turn on the camera.
2. Press the Mode button four times followed by the Shutter button to enter the camera's settings screen.
3. Press the Down button to locate the "Format" option.
4. Press the Shutter button, and the screen shows "Format Card? All data will be deleted".
5. Press the Shutter button again to complete the formatting progress.

Maintaining You Camera

1. For optimal audio performance, gently shake the camera or blow on the microphone to remove any debris from the microphone holes.



2. To clean the lens, use a soft, lint-free cloth to wipe it. Avoid inserting any foreign objects near the lens.
3. Do not touch the lens with your fingers.
4. Store the camera away from drops and bumps, as this may cause damage to the internal components.
5. Store the camera away from high temperatures and strong sunshine to protect it from damage.
6. Store the camera away from sharp objects and moisture-prone areas.

Maximizing Battery Life

A message appears on the touch display if the battery drops below 10%. If the battery reaches 0% while recording, the camera saves the file and powers off.

To maximize battery life, follow these guidelines when possible:

- Turn off the camera's Wifi.
- Capture video at lower frame rates and resolutions.
- Use the Screen Saver setting.

Battery Storage and Operation

1. If storing for extended periods, maintain a battery charge of 50-60%. Charge every 3 months and discharge the battery every 6 months.
2. Do not store the battery with metal objects such as coins, keys, or necklaces. If the battery terminals come close to metal objects, a short circuit may cause fire.
3. Store the battery in dry areas, safe from potential physical damage caused by squeezing or collision.
4. Avoid using or storing the battery at high temperatures, such as in direct sunlight or a hot compartment. The battery will heat up, malfunction, or have its service life shortened in these conditions.
5. Avoid using or storing the battery in low-temperature environments, as this will shorten the battery life or cause it to malfunction.



6. Avoid environments with strong static or magnetic fields; these can compromise the battery's protective unit, posing safety risks.
7. If the battery emits an odor, overheats, changes color, gets distorted, or exhibits any anomalies, discontinue use and remove it immediately from the camera or the battery charger whether it is being used, charged, or stored.
8. Safely insulate used electrodes to prevent potential hazards.

Remote

When the camera is turned on, it will be automatically connected to the remote within a certain distance. You can control the camera to take photos or record videos using the remote.

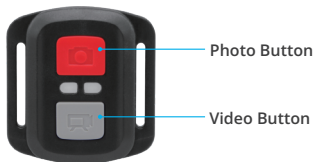

Note: The remote is not waterproof but splashproof only

Video

To record video, first make sure the camera is in Video mode, then press the Video button. The camera's working indicator will be flashing during video recording. To stop recording, press the Video button again.

Photo

To capture a photo, first make sure the camera is in Photo mode, then press the Photo button. The camera will emit a shutter sound indicating the completion of the shot.



Burst Photo

To capture burst photos, first verify the camera is in Burst Photo mode, then press the Photo button. The camera will emit a shutter sound indicating the completion of the shot.

Time Lapse

To capture time lapse photos or videos, first verify the camera is in Time Lapse mode, then press the Photo or Video button. The camera will emit a shutter sound indicating the completion of the shot.

Replacing the CR2032 battery of the remote

1. Use a screwdriver to remove the 4 screws on the back cover of the remote, allowing you to open it.



2. Remove another 4 screws on the remote's circuit board.



3. Lift the circuit board and slide out the battery, as shown below.

Note: Avoid rotating the circuit board to prevent reversing the remote control buttons.



4. Install the new battery, keeping the "+" pole facing up.

5. Install all 4 screws back onto the circuit board.



6. Install all 4 screws back into the cover.

Mounting Your Camera

Attach your camera to helmets, gear and equipment.





Contact Us

☎ (888) 466-9222 (US)

✉ cs@akasotech.com

🌐 www.akasotech.com

For any inquiries with AKASO products, please feel free to contact us, we will respond within 24 hours.

